

MECHANICAL LIFT PACKAGES



SASSI LIFT SYSTEMS IN PARTNERSHIP WITH OCTE OFFERING MODERNISATION AND NEW LIFT MRL PACKAGES

Who are **OCTE**?

- ⦿ OCTE is a major Independent manufacturer, located just south of Paris
- ⦿ More than 50 years of lift experience
- ⦿ Specialists in designing solutions for modernisation or new lift projects
- ⦿ Manufacturer of electrical and mechanical products for lifts
- ⦿ Manufacturer of patented lift products easy fit solutions
- ⦿ Customised lift concepts achieved using 100% OCTE products
- ⦿ Full Technical Assistance from conception to installation

What does this partnership offer?

- ⦿ A mechanical lift package designed specifically for the UK market
- ⦿ A collaboration of over 100 years combined lift industry experience
- ⦿ Combination of Alberto Sassi technical machine calculations and OCTE manufacturing know-how
- ⦿ UK based project management and unrivalled customer service
- ⦿ UK technical support
- ⦿ Full site survey at point of order
- ⦿ UK back-up every step of the way



Advantages of our partnership include...



Fast-Fit Solutions



Reduced Lead Times



Easy Assembly



Full UK Support



5 Year Machine Warranty*



UK Project Managed



EN81-20 Compliant



Modernisation Package





OCTE | CAR FRAME RANGE



ECONOMICAL

- Lightweight (Total weight: 180kg)
- Easy and quick to install. Separate components, easy to handle
- Bolted construction (Folded sheet steel galvanised 4mm)



ERGONOMIC

- Compact dimensions: Ideal for an existing building
- Safety gear and guide shoes integrated in the beams
- Reduced over travel



COMPLIANCE

- In accordance with EC Directive
- Standards EN 81-1+A3 and EN 81-21



**CAR
FRAME 2:1
2 LOWER
PULLEYS**



**CAR FRAME 2:1
2 UPPER PULLEYS**



**CAR FRAME 2:1
1 UPPER PULLEY**

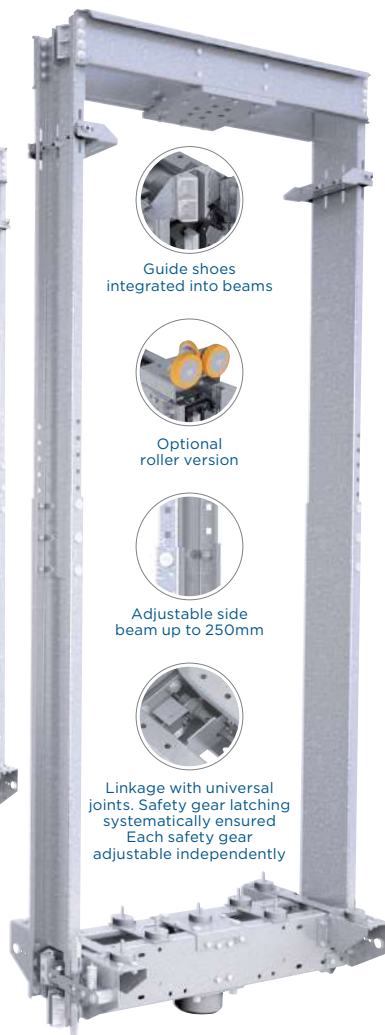

**CAR FRAME 1:1
SUSPENSION ROPES ABOVE**



Guide shoes
integrated into beams



Optional
roller version



Adjustable side
beam up to 250mm



Linkage with universal
joints. Safety gear latching
systematically ensured
Each safety gear
adjustable independently

OPERATING CONDITIONS

Duty load max	1050kg
P+Q max	2550kg
Rated speed max	1.60 m/s
T guide rails	9, 10mm drawn / 16mm machined
Between side frames	DBG (- 40mm)
LLH min*	2400mm (1)
Pit depth min	450mm (1)

*LLH: Lowest Level Height
(1) According to configuration



A

B

C

D

COMPRISING OF:

- 1 hitch plate for ropes or 1 or 2 pulleys
- 1 upper beam*
- 1 lower beam*
- 1 pair of upper isolation pads
- 1 lower isolation pad
- 2 side frames in 2 parts
- 4 guide shoes for T-guide rails
- 1 lower isolation pad
- 1 safety gear for T-guide rails, single or bi-directional progressive jaws

Galvanised sheet steel construction | *manufactured to suit DBG

		A	B	C	D
CONFIGURATIONS		CAR FRAME 1:1 SUSPENSION ROPES	CAR FRAME 2:1 1 UPPER PULLEY	CAR FRAME 2:1 2 UPPER PULLEYS	CAR FRAME 2:1 2 LOWER PULLEYS
Coupling plate	Ropes	$\varnothing 6\text{mm} \leq x \leq \varnothing 20\text{mm}$	$\varnothing 8\text{mm} / \varnothing 10\text{mm}$	$\varnothing 8\text{mm} / \varnothing 10\text{mm}$	$\varnothing 4 / \varnothing 6 / \varnothing 6,7 / \varnothing 8\text{mm}$
	No. of ropes	according to configuration			
Pulley(s)		-	$\varnothing 320 / \varnothing 400 / \varnothing 440\text{mm}$	$2 \times \varnothing 320 / \varnothing 400 / \varnothing 440\text{mm}$	$2 \times \varnothing 160 / \varnothing 240 / \varnothing 320\text{mm}$
Distance between guides max		1350mm			
Car external height		$6\text{mm} < x < \varnothing 20\text{mm}$ (50mm adjustable increments)			
Speed governor position		4 positions available			
Safety gear system		single-direction progressive or bi-directional progressive			
Safety gear position		below car			

OPTIONS



ROLLERS



POLYESTER PAINT FINISHES



COMpletely GALVANISED



OCTE | CAR FRAME RANGE (COMPACT)



COMFORT AND USE

- Reduced contact surface between car frame and guides, thanks to suspended rollers
- Eliminate shocks and vibration and ensure silent running: -10dB (A) compared to sliding shoes



KNOW-HOW

- The insurance of expert knowledge, OCTE have manufactured lifts since 1962
- Qualified car frame range in accordance with Annex IX and EN 81-20 & EN 81-21, ISO 9001 - ISO 14001

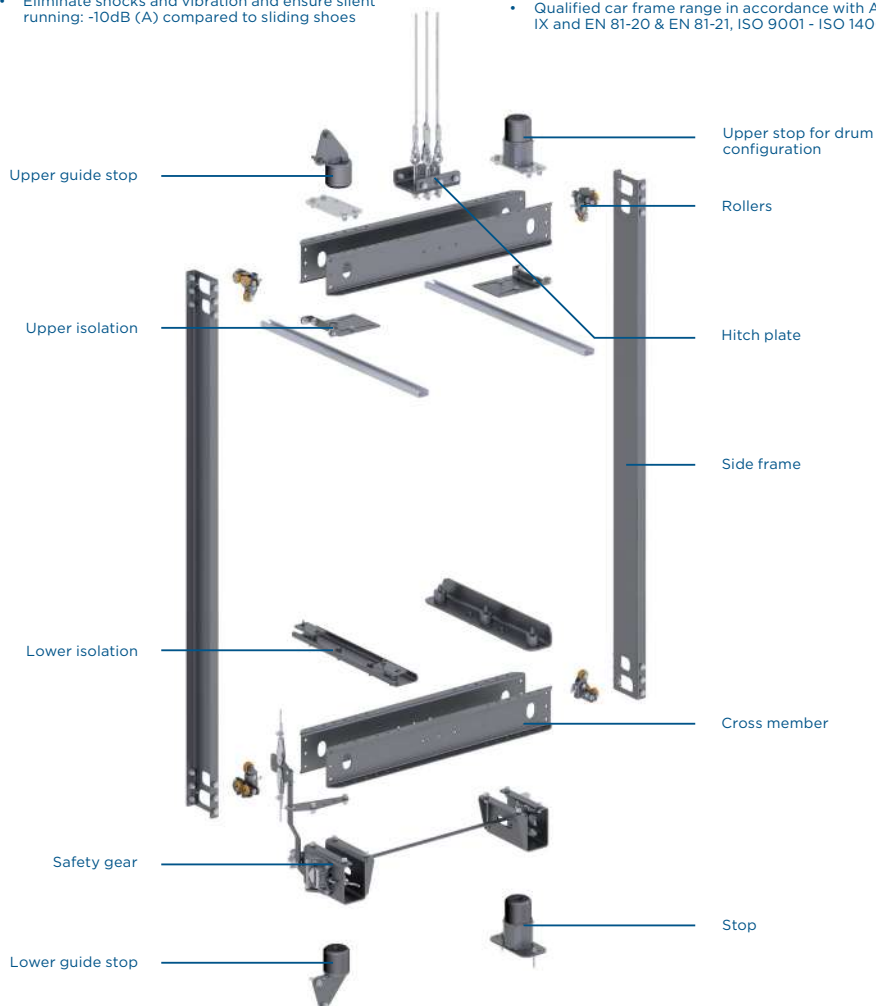

ENVIRONMENTAL PROTECTION

- Reduced environmental impact demonstrated by Life Cycle Analysis:
 - 15% less power consumption (friction suppression)
 - 20% less environmental impact (no guide lubrication)



READY-TO-INSTALL CONCEPT

- Ultra light car frame, reduced in size and weight
- Easy to assemble: Installation reduced from 3 to 2 days
- Simplified maintenance: Operating on dry guides

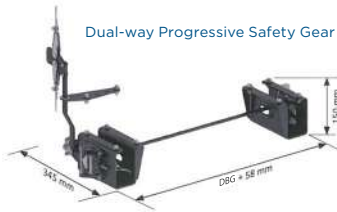

Dual-way Progressive Safety Gear

OPERATING CONDITIONS	
Type of T guides	9, 10 or 16mm
Duty loads	≤630kg
P+Q max	1500kg
DBG	450mm ≤ DBG ≤ 1300mm
Between side frame	DBG (-20mm)
Speed	≤ 1 m/s
HLL min	according to car
PIT min	610mm
Hitch plate	Spreader (option) or Ropes
Safety Gear	Dual-way progressive

COMPRISING OF:

- 1 hitch plate (according to ø and number of rope)
- 4 frame sections (manufactured to suit DBG)
- 1 pair of upper isolation pads
- 2 side frames (height std. 2800 or 2900mm)
- 1 pair of lower isolation pads
- 1 safety gear system for T guide rail, dual-way progressive including:
 - + 1 pair of safety gear blocks
 - + 1 linkage
 - + 1 manual remote switch prewired with cable H07 RN-F 2x1mm (5mm)
 - + 2 galvanised angle boxes for governor rope ø 6 to 6.5mm
 - + 2 galvanised rope clamps for governor rope ø 6 to 6.5mm
 - + 1 adjustment shim
- 2 lower stops (buffer included)

OTHER FRAMES AVAILABLE

≤ 630KG



OPERATING CONDITIONS	
Type of T guides	7, 8, 9, 10, 12, 14 or 16mm
Duty loads	≤630kg
P+Q max	according to DBG and car frame type
DBG	450mm ≤ DBG ≤ 2000mm
Between side frame	DBG
Speed	≤ 1 m/s
HLL Min	according to car
Hitch plate	Spreader (option) or Ropes
Safety Gear	single-way or dual-way progressive

≤ 1000KG



OPERATING CONDITIONS	
Type of T guides	7, 8, 9, 10, 12, 14 or 16mm
Duty loads	≤1000kg
P+Q max	according to DBG
DBG	500mm ≤ DBG ≤ 2000mm
Between side frame	DBG
Speed	≤ 1.60 m/s
Hitch plate	Ropes
Safety Gear	single-way or dual-way progressive



OCTE | CAR FRAME SAFETY GEAR ADAPTER CHANNEL (FOR T GUIDE RAILS)

≤ 630KG

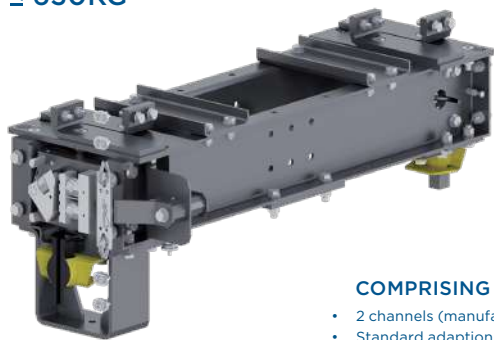

SPECIFICATIONS	
Type of T-Guide rails	7, 8, 9, 10, 12, 14 or 16mm
Duty load	≤630kg
DBG	450mm ≤ DBG ≤ 2000mm
Speed	≤ 1.00m/s
Safety gear type	Single-direction or bi-directional progressive

COMPRISING OF:

- 2 channels (manufactured to suit DBG)
- Standard adaption for existing car frame (2 models according to width)
- 4 guide shoes for T-Guide rail (ball joint or sprung according to configuration or 4 rollers)
- 1 stop plate
- 1 lower stop (buffer optional)
- 1 safety gear system for T-Guide rail, bi-directional progressive including:
 - + 1 pair of safety gear blocks
 - + 1 actuating linkage
 - + 1 manual remote switch prewired with cable H07 RN-F 2x1mm² (5m)
 - + 2 galvanised angle boxes for speed governor rope ø 6mm
 - + 4 galvanised cable clamps for speed governor rope ø 6mm

(Also available for Round Guides)

≤ 1000KG

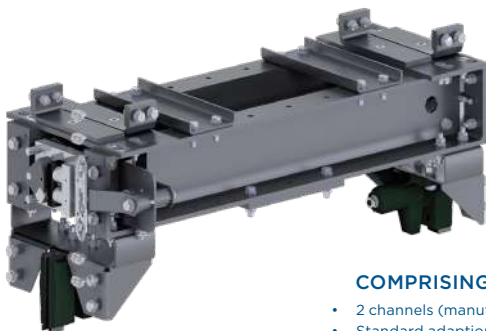

SPECIFICATIONS	
Type of T-Guide rails	7, 8, 9, 10, 12, 14 or 16mm
Duty load	≤1000kg
DBG	500mm ≤ DBG ≤ 2000mm
Speed	≤ 1.60m/s
Safety gear type	Single-direction or bi-directional progressive

COMPRISING OF:

- 2 channels (manufactured to suit DBG)
- Standard adaption for existing car frame (2 models according to width)
- 4 guide shoes for T-Guide rail (ball joint or sprung according to configuration or 4 rollers)
- 1 stop plate
- 1 lower stop (buffer optional)
- 1 safety gear system for T-Guide rail, bi-directional progressive including:
 - + 1 pair of safety gear blocks
 - + 1 actuating linkage
 - + 1 manual remote switch prewired with cable H07 RN-F 2x1mm² (5m)
 - + 2 galvanised angle boxes for speed governor rope ø 6mm
 - + 4 galvanised cable clamps for speed governor rope ø 6mm



OCTE | CAR FINISHES RANGE



1. CEILINGS

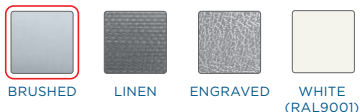

2. PANELS*



ACCESSORIES

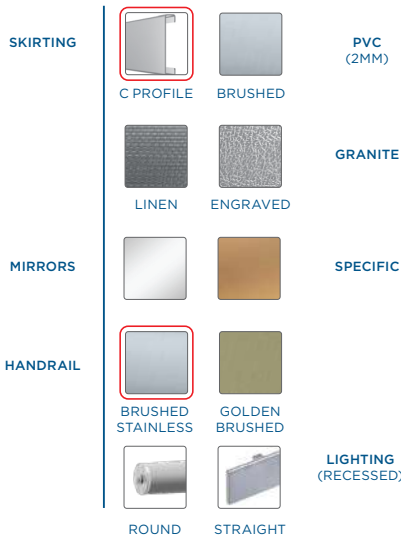

3. FLOORS*



LIGHTING

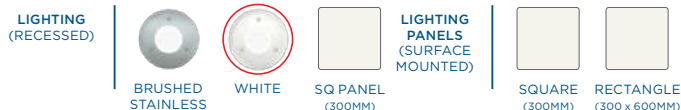



OCTE | MRL (MACHINE ROOM LESS) PACKAGES

COMPLIANCE

- EN 81-20 Compliant

DUTY LOAD

- 180Kg - 630Kg

CONFIGURATION

- Upto 30mtr Travel
- Up to 15 Floors
- Up to 1m/s

SIZE

- Headroom Minimum: 2600mm *
- Pit Minimum: 300mm **
- Shaft Minimum: 1180mm (W) 1010mm (D) ***
- Clear Door Opening minimum: 600mm ***
- Standard Pit Depth to EN81-20: 1.2mtrs
- Certificate of Conformity

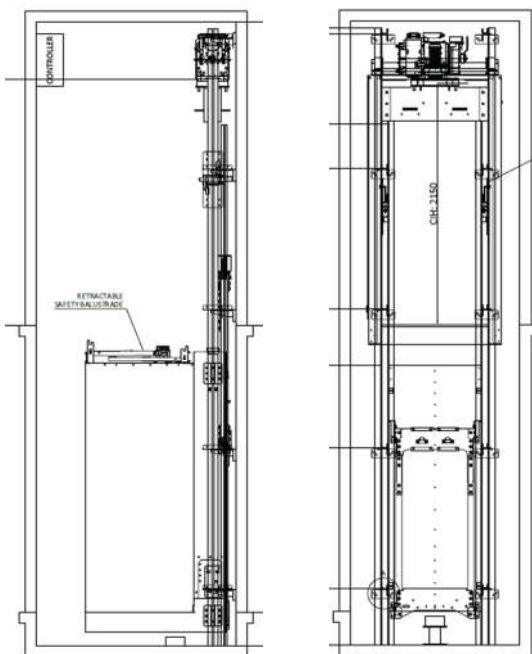

180kg



240kg



320kg



400kg



450kg



525kg



630kg

* Compliance to EN81-20 ** Dispensation to EN81-21 Required *** To specific configuration

New Lift Package - Residential Example



OCTÉ

Type: 2/1 **Capacity:** 630kg **Speed:** 1.0m/s **Travel:** 6mtr **Floors Served:** 3

- **G200-TC** with 210mm-6x6.7mm Standard Traction Sheave, V3F Motor, 4.4Kw (synch), 25Hz, 182rpm, 180st/hr, 400v (3 Phase), 40%ED, 205vDC Disc Brake, complete with Rope Jump Guard, Brake Monitoring Switches (A3) and ENDAT Absolute Encoder with 10m of Cable.
- **MRL Bedframe** and Isolation, mounted onto the Guides
- **Brugg TSR Ropes** 6no x Dia 6.7mm, Anchorages, Fixings and Load Weighing
- **OCTÉ 8, TEO MRL - 2:1, Cantilever Car Sling** (EN81-20)
- Isolation, Roller Guides, Oil Pots, Collectors, Central Buffer Plate and Toe Guard
- SLC Bi-Directional Progressive Safety Gear
- (A3) Overspeed Governor, Tension Weight, Rope and Guarding
- Car Polyurethane Buffer and Support
- 3x 210mm-6x6.7mm Divertors
- 3x Car Top Fixed Safety Rails (EN81-20)
- **Counterweight**, Fillers, Guides (5.0mtr-45x5x5), Brackets and Fixings
- Self-Aligning Guide Shoes, Oil Pots, Collectors and Central Buffer Plate
- Counterweight Screen - 2.5mtr High
- Counterweight Polyurethane Buffer and Support
- **Car Size** (minimum) 1400 (D) x 1100 (W) x 2100 (H) (1.42m²)
- **Car to specification** (Finishes to be advised)
- Anti-Vandal (EN81-71) 4xLED Spots (Emergency Lighting), White Powercoated Ceiling, 304 Grade St/St Front Return, Rear, LH and RH Wall, Handrail and Ventilation. 30/10 Sealed Tray, Non-Slip PVC Flooring + Half Mirror
- **Car Operating Panel** (EN81-71) FH Surface Mounted, Dual Illumination US91, Alarm Open/Close Button, Buzzer, Key Switch, TFT Indicator and Engraving.
- **1 x Car Door** Fermator Premium Sovereign, 2PSO 800x2000mm set. 304 Brushed St/St, Panel filled with Mineral Wool and Aluminium Door Track.
- **3 x Landing Doors** Fermator Premium Sovereign, 2PSO 800x2000mm, Fire Rated E120 (EN81.58), 304 Brushed St/St, Panel filled with Mineral Wool and Aluminium Door Track. Architrave and Safety Edge: By Others
- **LOP** (EN81-71) featuring 4.3" TFT Indicator, US91 Pushes, Gong and Buzzer
- **DAC Dynapro VF MRL Controller - <5.5KW, 13AMP**, (EN81-71) St/St Wall Cabinet, Kubler Shaft Positioning, Lift Shaft Limits, Engineers CTC, 100 Way Half Way Box, EN81-20/50 Equipment, Firefighting + Evacuation Control, Trailing Cables 24 Core PVC Trailer, 20 and 2 PVC Screened Pair, Wedge Clamp, MRL A3, Equipment, UPS Brake Unit, ECO Mode



OCTE | MRL (MACHINE ROOM LESS) PACKAGES

TWO PANEL SIDE OPENING / AUTOMATIC DOORS - CW SIDE

RATE LOADED	180Kg	240Kg	320Kg	400Kg	450Kg	525Kg	630Kg
Number of Persons	2prs	3prs	4prs	5prs	6prs	7prs	8prs
Roping	1:1	1:1	1:2	1:2	1:2	1:2	1:2
Motor Power	2.5kW	2.5kW	4.4kW	4.4kW	4.4kW	4.4kW	4.4kW
Motor Current	8A	8A	13A	13A	13A	13A	13A
Shaft Width SW	1180mm	1280mm	1380mm	1580mm	1480mm	1580mm	1580mm
Shaft Depth SD	1200mm	1300mm	1400mm	1400mm	1600mm	1600mm	1800mm
Car Width CIW	700mm	800mm	900mm	1100mm	1000mm	1100mm	1100mm
Car Depth CID	800mm	900mm	1000mm	1000mm	1200mm	1200mm	1400mm
Car Area m ²	0.56m ²	0.72m ²	0.90m ²	1.10m ²	1.20m ²	1.32m ²	1.54m ²
Door Width PL	600mm	700mm	700mm	800mm	800mm	900mm	900mm

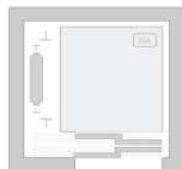

TWO PANEL SIDE OPENING / AUTOMATIC DOORS - CW BACK

RATE LOADED	180Kg	240Kg	320Kg	400Kg	450Kg	525Kg	630Kg
Number of Persons	2prs	3prs	4prs	5prs	6prs	7prs	8prs
Roping	1:1	1:1	1:2	1:2	1:2	1:2	1:2
Motor Power	2.5kW	2.5kW	4.4kW	4.4kW	4.4kW	4.4kW	4.4kW
Motor Current	8A	8A	13A	13A	13A	13A	13A
Shaft Width SW	1100mm	1100mm	1280mm	1280mm	1280mm	1280mm	1280mm
Shaft Depth SD	1420mm	1620mm	1720mm	1720mm	1920mm	1920mm	2120mm
Car Width CIW	800mm	800mm	900mm	1100mm	1000mm	1100mm	1100mm
Car Depth CID	700mm	900mm	1000mm	1000mm	1200mm	1200mm	1400mm
Car Area m ²	0.56m ²	0.72m ²	0.90m ²	1.10m ²	1.20m ²	1.32m ²	1.54m ²
Door Width PL	600mm	600mm	700mm	700mm	700mm	700mm	700mm

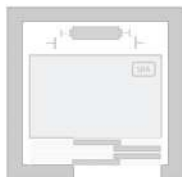

i COUNCIL SPECIFICATION AND BESPOKE FINISHES ALSO AVAILABLE

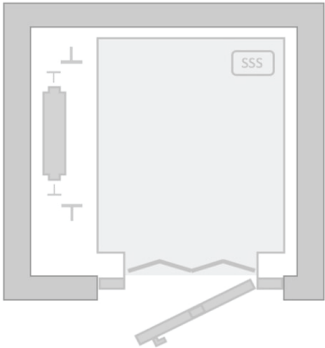

ONE ACCESS MANUAL DOOR
CW SIDE

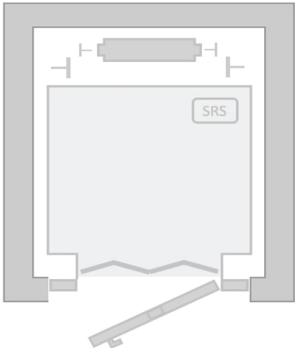

ONE ACCESS MANUAL DOOR
CW BACK

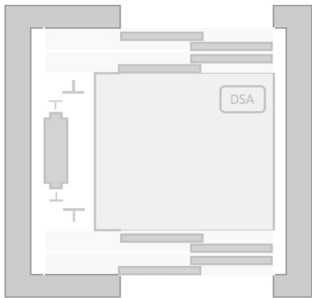

TWO ACCESS AUTOMATIC DOORS
CW SIDE

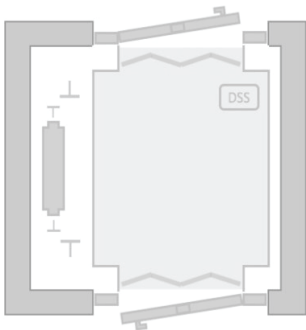

TWO ACCESS MANUAL DOORS
CW SIDE



TWO ACCESS AUTOMATIC DOORS
90° CW BACK



OCTE | PACKAGES AVAILABLE

METO



GEARED



GEARLESS



1/1



2/1



1.60M/S



300kg



450kg



630kg



750kg



900kg



1000kg+



NEMO



GEARED



GEARLESS



1/1



1.00M/S



180kg



300kg



450kg



630kg



OTHER FRAMES AVAILABLE



1.00M/S

UPTO



630kg



1.60M/S

UPTO



1000kg+



GEARLESS



1/1
UP TO
3 PERSON



2/1
UP TO
8 PERSON



1.00M/S



180kg



240kg



320kg



400kg



450kg



525kg



630kg

CARS



GALVANISED SHEET CAR



HIGH RESISTANT CAR



GLASS



AVAILABLE FINISHES INCLUDE



STAINLESS
STEEL



EPOXY
PAINT



LAMINATE



WOOD



GLAZED



PVC



GRANITE



SPECIFIC

OPTIONAL EXTRAS ON REQUEST:



CONTROLLERS



DOORS



ACCESSORIES



OCTE | CONTROLLERS & OPERATING SYSTEMS

TRACTION & MRL CONTROLLERS



SASSI LIFT SYSTEMS IN PARTNERSHIP WITH DIGITAL ADVANCE CONTROLS

Available as an additional extra, Sassi Lift Systems have teamed up with Digital Controls to offer an extensive range of traction controllers to integrate with our OCTE lift packages. Available for New lift or MRL we can offer a package that suits your application. Working with Digitals we are offering two companies extensive knowledge for the price of one.

If you would rather select your own Controller all SASSI / OCTE packages have been designed to work in tandem with all UK and leading Controller manufacturers.

FEATURES OF A DIGITAL ADVANCE CONTROL:

- UK Manufactured and supported
- High performance 32bit Micro-processor control
- Open protocol with user-friendly and intuitive menus and structure.
- Serving up to 48 floors
- Speeds up to 4 M/S
- Simplex or up to 8 car group control.
- Serial connection for DAC TFT and Dot Matrix indicators.
- Serial call, car and drive connection (MEC32S & R Only).
- Serial connection for DAC Laser and shaft encoder positioning system
- Fault & Event logging
- Quick delivery.
- Vacon VVVF Drive up to 50KW for speeds up to 1 M/S
- Ziehl Abegg VVVF Drive up to 50KW for speeds above 1 M/S
- Full set of encapsulated controller drawings
- Consumer unit for lift well power
- Inner door on our standard range of cabinets
- A3 Compliance
- 5 Year Guarantee on all MEC32 Microprocessor Boards.
- 3 Year Guarantee on all other components including Vacon & Ziehl Abegg Drives.



CAR & LANDING OPERATING SYSTEMS

Digital Advanced Control offers both a standard and bespoke range of car & landing operating stations manufactured in high quality satin stainless steel. Our car operating stations are available in either surface or flush mounted arrangements for full height, half height or customer designed application.

In order to meet the requirements of end users, architects, consultants and other specifying bodies, we are pleased to provide our surface mounted car stations in three different designs, these being angular edge, straight edge or the all new radius edge style. All of which are available in a vandal resistant design including the laser cut pepper-pot style of the indicator panel.

Our car stations are specifically designed to a very high standard and come prepared for our comprehensive range of push buttons, button buzzer, key switches, dot matrix or TFT indicators. We are also able to accommodate third party equipment such as auto diallers and intercom systems complete with all necessary engraving requirements including customer logos.



FEATURES:

- Stainless steel manufacture
- Surface or flush mounted
- Vandal resistant options
- Standard or bespoke design



OCTE | INDICATORS



CLEAR VIEW TFT LCD INDICATORS

We offer a Clear View range of TFT (Thin Film Transistor) LCD indicators manufactured within our UK based factory and utilising the latest surface mount technology. This gives an extremely reliable and user friendly set of TFT LCD indicators for fitting to either existing lift controllers or new Digital Advanced Controllers.

These TFT LCD indicators are manufactured from high quality components and consist of full colour chip on glass TFT's. This provides up to 16.7 million colours and has a total resolution of 480 x 272 pixels in a 4.3" or 800 x 480 pixels in a 7" display giving outstanding viewing resolution and clarity.

FEATURES:

- UK Manufactured and supported
- 32 bit ARM7TDMI microprocessor technology
- Fully reprogrammable on site from either the MEC32 Controller or encoder card
- Wide viewing angle greater than 160° (no need for separate side arrows)
- On-screen real time and date derived from the super accurate real-time clock
- Large 4.3 or 7 inch screen
- Full colour graphics with up to 16.7 million colours
- High resolution for greater clarity
- Accepts PNG, JPG and GIF formats for backgrounds and logos
- Plug-in gongs available
- Can be used in conjunction with our SF750 indicators (Mix & Match)
- Graphical symbolic messages as well as clear English messages



DOT MATRIX INDICATORS

Alternatively a comprehensive range of Dot Matrix indicators is available for use with either existing lift controllers or new Digital Advanced Controllers for the lift car and at the landing entrances. Our SF750 Dot Matrix range is available in heights of 30mm or 50mm and a colour range of Red, Blue and Green.

The 30mm Dot Matrix indicator is mountable in either the horizontal or vertical plane making for a versatile fitting arrangement in such places as narrow landing architraves with depth limitations. The 50mm Dot Matrix indicator is a horizontal arrangement only with characters meeting the DDA height requirement.

The SF750 range of dot matrix indicators utilises the latest surface mount technology to give a reliable and user friendly set of dot matrix indicators. The indicators communicate either with our separate encoder in the case of a third party lift controller or directly with the MEC32(R) control system via Controller Area Network (C.A.N) protocol. The indicators are fully reprogrammable on site without the need for a laptop computer.

FEATURES:

- 30mm, 50mm versions
- Fully reprogrammable on site from either the MEC32 Controller or encoder card
- Horizontal and Vertical versions
- Available colours - Red, Green & Blue
- Plug-in gongs and Side Arrows
- Can be used in conjunction with our TFT indicators (Mix & Match)





OCTE | EXTRAS - BALUSTRADES

FIXED

COMPRISING OF:

- Galvanised steel structure
- 6 screws CHC M6 x 12 | 2 washers M6 | 8 bolts H M8 x 30
- 8 washers M8 | 8 lock washers M8 | 8 nuts H M8
- 8 coach bolts H VB 8x30

FURTHER INFORMATION:

- Complies with: EN 81-20
- Weight: 17.6 kg | Maximum width: 1500 mm
- Height: 1100 mm | Plinth : (height) 150 mm
- Installation on car roof with low stop (1150 mm)

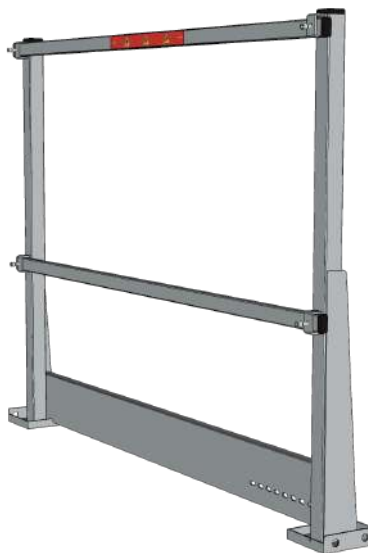
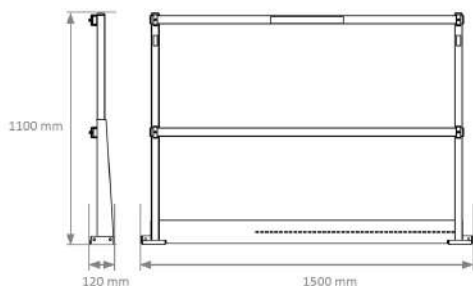

RETRACTABLE

COMPRISING OF:

- 2 posts + 2 electrical contacts with cables (L 2.50 m) and contact bridges
- 2 iron tubes
- 1 toe board
- Fixings included

FURTHER INFORMATION:

- Complies with: EN 81-20, EN 81-21
- Designed for installations with reduced top clearance

SIZES		
Height (Ref)	700mm (CSRR0703)	1100mm (CSRR01103)
Weight	14.8kg	17.6kg
Max. width	1595mm	
Deployed height	706mm	1111mm
Retracted height	499mm	704mm
Contact	Pull-off contact, max. volatge: 500 V	
Cables	3G1 mm ² (PC20), 2x1mm ² (SC16)	
Toe board height	150mm	



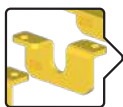

OCTE | EXTRAS - HANDLING HOOKS

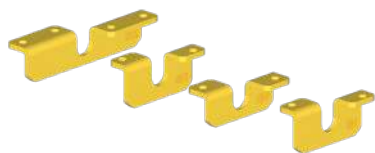

COMPRISING OF:

- Handling hook (weight: 2,7 Kg - « engraved » stamp)
- 2 dowels RAWL (5 KN - 10 KN - 15 KN)
- 4 dowels RAWL (20 KN)

SIZES								
	A	B	C	D	E	F	G	Max load
5 KN	12	102	200	50	100	2x ø20	-	≤500kg
10 KN	12	122	200	50	80	2x ø20	-	≤1000kg
15 KN	12	102	200	50	100	2x ø20	-	≤1500kg
20 KN	12	102	350	50	80	2x ø20	100	≤2000kg

FURTHER INFORMATION:

- Compliant with: EN 81-20
- Hook material: Formed | Finish: yellow | Maximum admissible load: between 500 kg and 2000 kg depending on model
- Installation Notes: Before putting into service, check the strength of the support (concrete integrity) and have the installation checked by a structural engineer. Must be fixed to the ceiling of the machine or pulley room or at the top of the shaft.



OCTE | EXTRAS - PIT LADDERS

TILT LADDER

COMPRISING OF:

- Single section aluminium ladder - Height 2.40m
- 1 built-in support, fitted with a pre-wired safety contact (L 5 m)
- Fixings included

FURTHER INFORMATION:

- Compliant with: EN 81-20
- Ladder material: Aluminium | Dimensions: 390 x 77 x 2400 mm
Weight: 5.0 kg | Maximum load: 150 kg | Cable H07Rn-F 3G1 mm (L 5 m)
- Installation Notes: Intended for use in pits where the depth is at most 1.10 meters. Fixed inside the shaft, easily accessible from the landing. Must not interfere with any of the moving parts of the lift.

FIXED LADDER

COMPRISING OF:

- Single section aluminium ladder - Height 2.40m
- 4 supports
- Fixings included

FURTHER INFORMATION:

- Compliant with: EN 81-20
- Ladder material: Aluminium | Dimensions: 365 x 270 x 2400 mm
Weight: 4.1 kg | Maximum load: 150 kg
- Installation Notes: Intended for use in pits where the depth is at most 1.30 meters. Fixed inside the shaft, easily accessible from the landing. Must not interfere with any of the moving parts of the lift.





Sassi Lift Systems Ltd

5 Blackwell Drive, Springwood Industrial Estate, Braintree, Essex, CM7 2QJ, UK

T 01376 550666 | **E** sales@sls-ltd-co.uk | **W** sls-ltd.co.uk

